

# StudioTech

## Model PS-3

Modular Audio/Video  
Component Rack

### Specifications

#### Weight Limit Recommendation (in lbs.)

200
150
200

Note:  
Total weight not to  
exceed 300 lbs

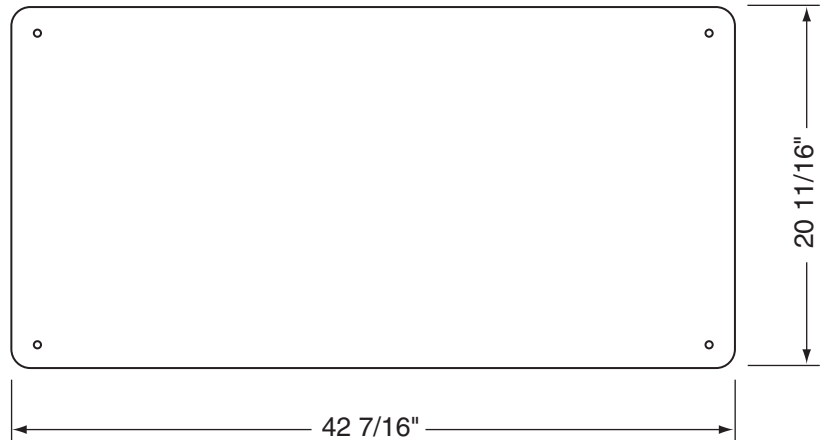

**TOP VIEW**

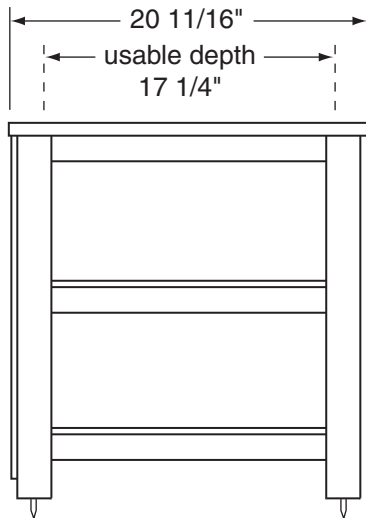

**SIDE VIEW**

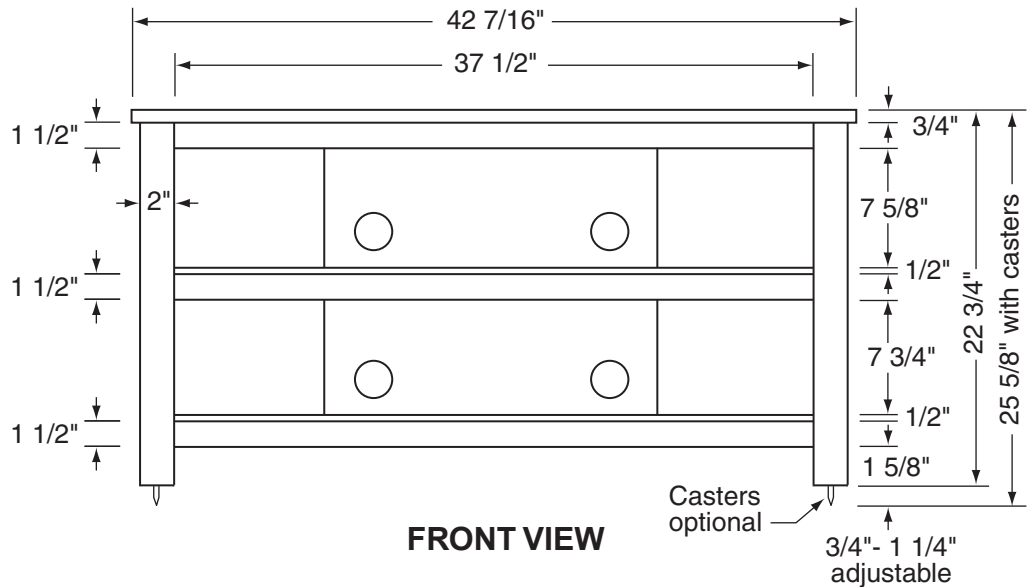

**FRONT VIEW**

### PS-3

Dimensions (h x w x d)	22 3/4" x 42 7/16" x 20 11/16"
Number of Shelves	3
Weight Capacity per Shelf	see diagram above
Shelf Spacing (bottom to top)	7 3/4", 7 5/8"
Usable Shelf Size (w x d)	37 1/2" x 17 1/4"
Wood Finishes	Black Lacquer
Steel Frame Finishes	Black or Silver
Carpet Spikes	included
Vinyl Glides	included
Rolling Casters	optional
Cable Management	included